

Big Daddy Games is compatible with *Pyramid Technologies Phoenix* Thermal Printer.

For best security, it is highly recommended that the *Phoenix* Printer model *SEN-02* with firmware version is *1.15* in **SERIAL MODE**.

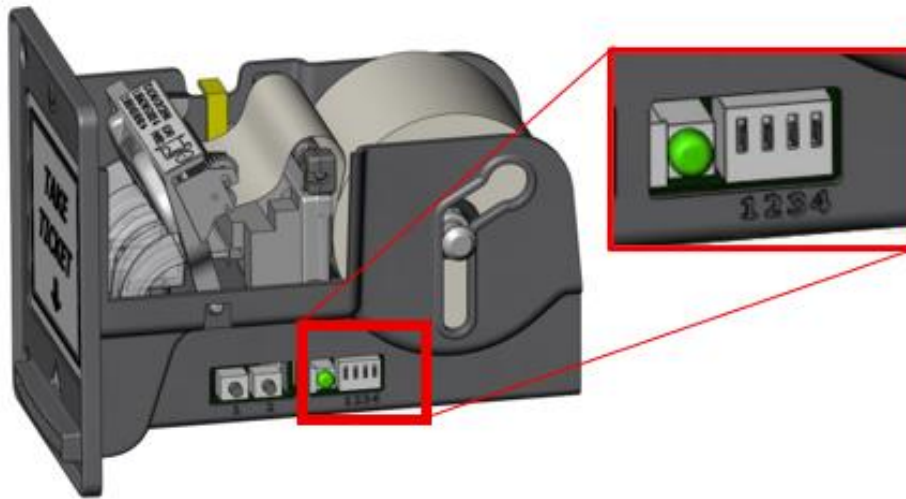

## **Setting Phoenix Printer to PULSE Mode**

DIP Switch 1 must be **ON (DOWN)** and DIP Switch 3 and 4 must be set to **OFF (UP)**.

ON ↓	OFF ↑	OFF ↑	OFF ↑
DIP 1	DIP 2	DIP 3	DIP 4

## **Setting Phoenix Printer to SERIAL Mode**

DIP Switch 1 and 3 must be set to **ON (DOWN)**.

ON ↓	OFF ↑	ON ↓	OFF ↑
DIP 1	DIP 2	DIP 3	DIP 4

## Setting Phoenix Printer to print QR Codes

Hold in the second button on the Phoenix Printer until a QR code is printed (5-10 seconds).  
Label the QR code of what Game # the QR code printed from.

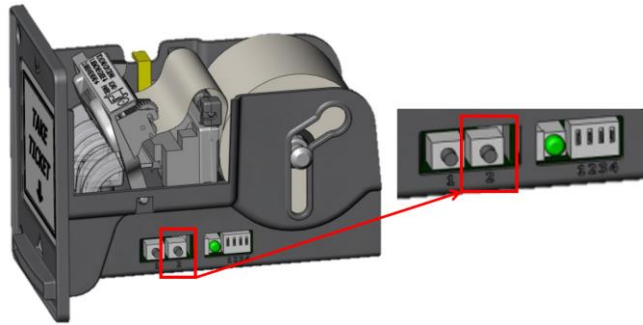

## Max Connect Sidecar Phoenix Printer Setup

The printer must be labeled as **PTD-U-REV3** for this to work (The label is underneath the printer.) You CANNOT use a game printer for the Sidecar. If you want to convert a game printer to a sidecar one you must load our configuration file **PTD-U-REV3.phg** to the printer using Phoenix Tools.

1. Install printer into the Sidecar
2. Switch dip switches 1,2,3 on (down position) and 4 off (up position)
3. Plug in USB from the printer to USB Hub
4. Plug in printer power

## Pairing Phoenix Printer Sidecar Sentry to Genmega Kiosk

The printer must be labeled as **PTD-U-REV3** for this to work (The label is underneath the printer.) You CANNOT use a game printer for the Sidecar. If you want to convert a game printer to a sidecar one you must load our configuration file **PTD-U-REV3.phg** to the printer using Phoenix Tools.

1. Make sure printer is powered on and plugged in
2. Make sure the Sidecar is in Sentry mode under Config settings
3. Hold the button on the right side towards the back of the printer for around 10 seconds until a pairing code prints out (It should be right next to the Dip switches)
4. Use the pairing code on the kiosk (See kiosk manual for more information)

ON ↓	ON ↓	ON ↓	OFF ↑
DIP 1	DIP 2	DIP 3	DIP 4